

# PIPE TEMPERATURE TRANSMITTER (GPTO-420)

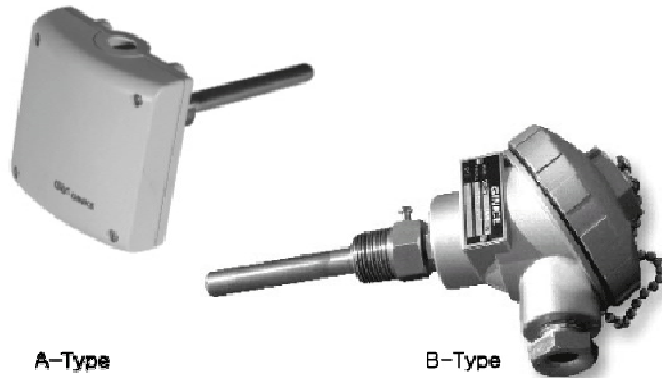

## Application

---

"GPTO" Pipe Temperature Transmitter is intended for sensing pipe and tank temperature ;

- Fluids temperature control and limit
- Circulating water temperature control and limit
- Water temperature at tank control and limit

## Technical Data

---

- Supply Voltage : DC 15 ~ 30V
- Output Signal : 4 ~ 20 mA
- Range : ① 0 ~ +150°C, ② -30 ~ + 70°C  
③ -50 ~ +50 ④ -20 ~ +200°C
- Accuracy :  $\pm 0.3^{\circ}\text{C}$
- Wiring : 2 Wire
- Sensing Time : Approx. 30 Sec (Without WELL 10sec)
- Ambient Temperature :
  - 1) On operation: -30 ~ +150°C
  - 2) On Storage: -10 ~ +80°C
- Ambient Humidity : 5 ~ 95%Rh
- Cable Fitting : PF 1/2"
- Protection Class : IP 54

- Weight : 0.46 Kg( w/well )
- Length : 130 mm
- Cover : Aluminum die-cast ( B Type)
- WELL : SS304

## Notes

---

- Use drill bar for WELL at over 6Kg/cm of Nominal pressure.
- Install Transmitter to following location per each different usage
  - 1) Hydraulic temperature control (for cold and warm water)
    - In case of installing inside of hydraulic body: right behind of pump
    - In case of installing on the line of ventilating water: away from 1.5 ~ 2 meter away from mixed valve
  - 2) Ventilating water temperature control
    - Install inside of Pipe to sense accurate limit temperature at the location of well water mixing point
- Install WELL at elbow location to be reversed from Hydraulic.

## Wiring Diagram

---

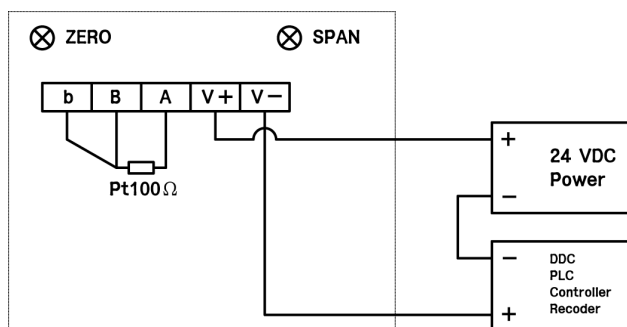

## Dimension

A Type

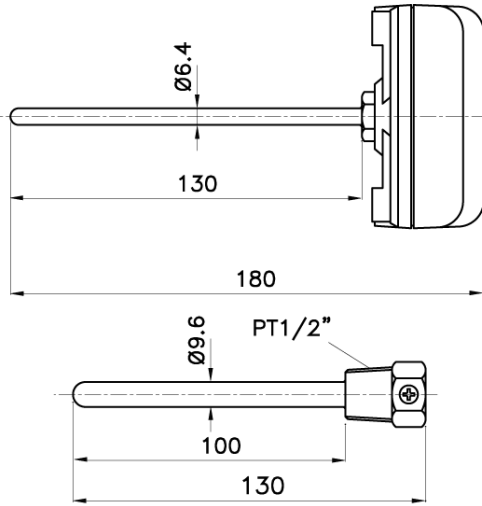

B Type

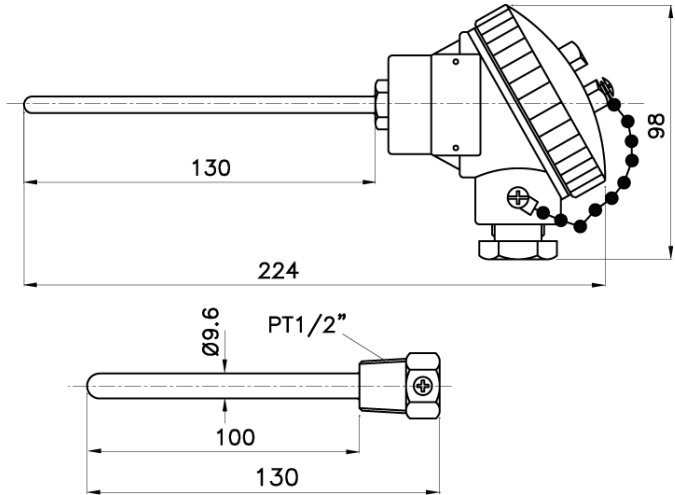

## Installing Methods

A) Installing on bent pipe

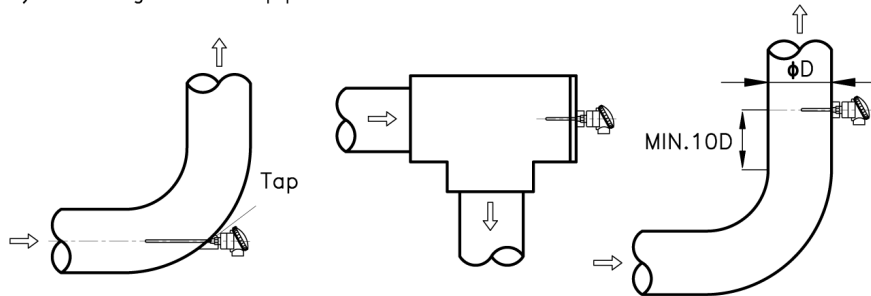

B) Installing on straight pipe



C) Installing on narrower pipe

