

## PIPE TEMPERATURE SENSOR (GPT-100)

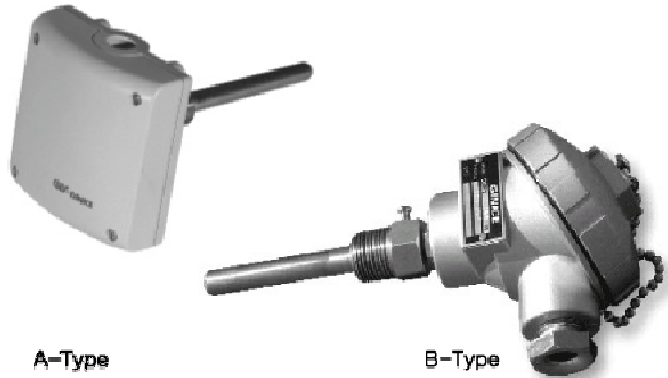

### Application

---

"GPT" Pipe Temperature sensor is intended for immersion mounting in pipes, and tanks.

The immersion tube is made of stainless steel.

- TEMPERATURE CONTROL AND LIMITING FOR FLUIDS
- TEMPERATURE LIMITING FOR CIRCULATING WATER
- WATER TEMPERATURE CONTROL FOR TANK

### Technical Data

---

- SENSING ELEMENT : Pt100Ω
- SENSING RANGE : -30 ~ +150℃
- ACCURACY : ±0.3℃(at 0℃)
- SENSING TIME : About 30sec(Without WELL 10sec)
- AMBIENT TEMPERATURE :
  - 1) On Operation : -30 ~ +90℃(A-Type), -30 ~ +150℃(B-Type)
  - 2) On Transportation : -15 ~ +100℃
  - 3) On Storage : -10 ~ +80℃
- AMBIENT HUMIDITY : 5 ~ 95%Rh
- APPLICATION : DDC System and controller
- CHARACTERISTICS : Table of Reference Values
- WIRE : 3 wires, 1.0mm<sup>2</sup>
- CABLE FITTING : PF 1/2"
- WEIGHT : 0.430Kg(W/WELL)
- WELL LENGTH : 130mm

- PROTECTION CLASS : IP 54
- COVER : Aluminum die-Cast (B Type)
- WELL : SS304

## Notes

---

- Use Drill Bar for WELL in case of over 6Kg/cm<sup>2</sup> of Nominal Pressure
  - Install the Sensor to the following location depend on each usage :
    - 1) In case of controlling temperature for Fluids objects ( Warm & Cold water )
      - In case of installing the pump inside of Fluids :  
Install at the behind of Pump
      - In case of installing the pump on the line of circulating water :  
Install 1.5 ~ 2m away from Mixed Valve
    - 2) In case of controlling temperature for circulating water
      - For accurate control of temperature, Sensor should be installed at inside of circulating pipe, and installed at the place where water can be mixed well..
- ※ WELL should be installed at the Elbow for the reverse direction from Fluids

## Wiring Diagram

---

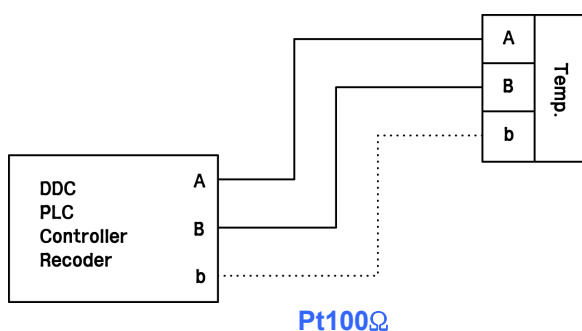

## Dimension

A Type

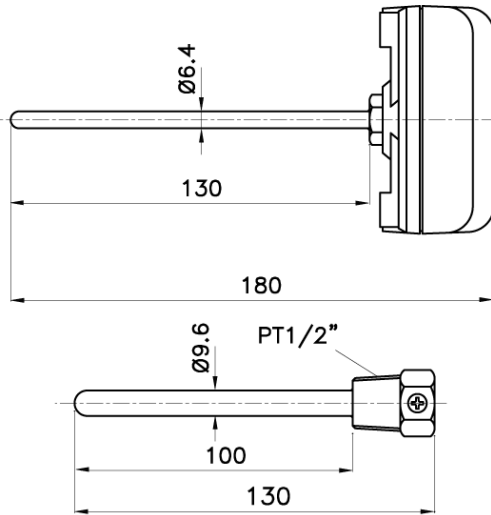

B Type

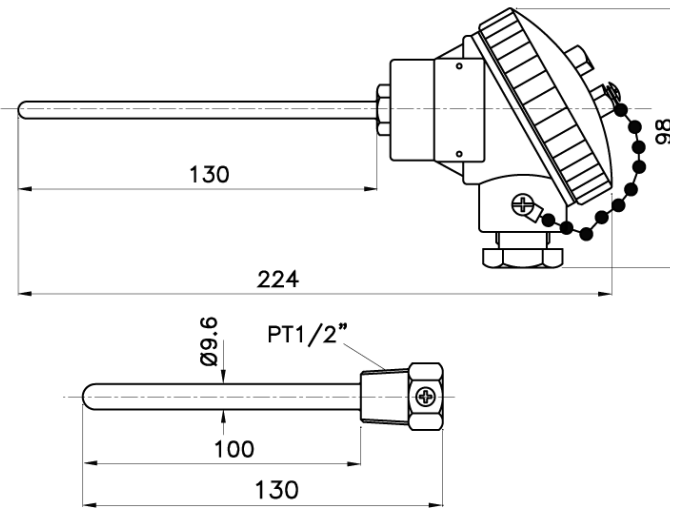

## Installing Methods

A) Installing on bent pipe

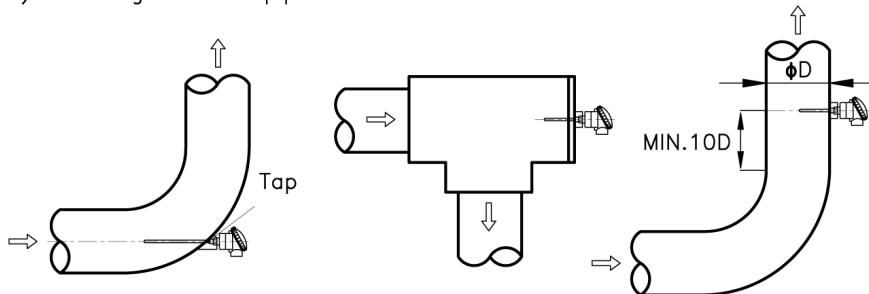

B) Installing on straight pipe



C) Installing on narrower pipe

